



2027 SCOTT
SPARK RC MANUAL

CONTENT

THE SPARK RC SHOULD BE ADJUSTED EXACTLY TO THE RIDER FOR MAXIMUM SAFETY AND RIDEABILITY.

This manual provides a summary of the primary operating functions of the Spark RC. It is not intended to serve as a comprehensive guide for service or maintenance procedures.

For detailed assistance, please consult an authorized SCOTT dealer to help prevent any technical issues, damage or harm.

GEOMETRY	03
TECHNICAL DATA	04
SEATPOST INSERTION	05
INTEGRATED CABLE ROUTING (ICR)	07
HEADSET ADJUSTMENT	08
SAVE THE DAY KIT	17
BOTTLE CAGE BRACKET	19
SETTING SAG	21
GENERAL SPARE PARTS	22
MANUFACTURE'S GUARANTEE	30

LEGEND



TORQUE AMOUNT



TORX TOOL SIZE



HEX TOOL SIZE



GREASE REQUIRED



NO GREASE REQUIRED



CARBON GREASE



THREADLOC REQUIRED



BEARING FIT REQUIRED



ANTI-SEIZE



REVERSE THREAD

SPARK RC

GEOMETRY

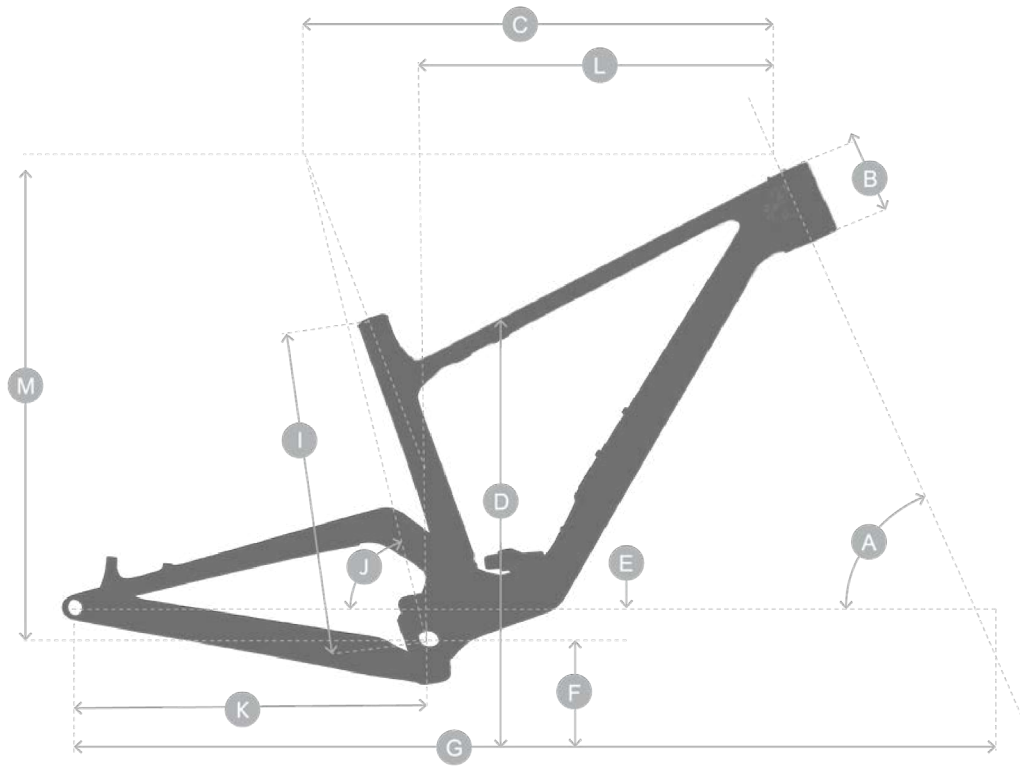

2027 SPARK RC		SMALL	SM-0.5°	SM+0.5°	MED	MD-0.5°	MD+0.5°	LARGE	LG-0.5°	LG+0.5°	XL	XL-0.5°	XL+0.5°
A	Head tube angle °	65.9	65.5	66.3	65.9	65.5	66.3	65.9	65.5	66.3	65.9	65.5	66.3
B	Head tube length mm	88	88	88	88	88	88	95	95	95	112	112	112
C	Top tube horizontal mm	573	572.3	573.7	610.1	610.8	609.4	636.7	636	637.5	665.8	665	666.7
D	Standover height mm	732.7	732.7	732.7	474.2	474.2	474.2	766.7	766.7	766.7	790.4	790.4	790.4
E	BB offset mm	-44	44.9	43.1	-44	44.9	43.1	-44	44.9	43.1	-44	44.9	43.1
F	BB height mm	332.5	331.6	333.4	332.5	331.6	333.4	332.5	331.6	333.4	332.5	331.6	333.4
G	Wheelbase mm	1154.7	1159.1	1150.2	1179.7	1184.1	1175.2	1207.5	1212	1203.1	1239.5	1244	1235
I	BB center to TST mm	385	385	385	410	410	410	460	460	460	510	510	510
J	Seat angle °	76.4	76.5	76.3	75.3	75.4	75.2	75.3	75.4	75.2	75.3	75.4	75.2
K	Chainstay mm	434	434	434	434	434	434	434	434	434	434	434	434
L	Reach mm	430	429.1	430.9	455	454.2	455.9	480	479.2	480.8	505	504.2	505.7
M	Stack mm	591.1	590	592.1	591.1	590	592.2	597.5	596.3	598.6	613	611.8	614.2
	Fork Rake mm	44	44	44	44	44	44	44	44	44	44	44	44
	Trail mm	120.2	123.1	117.3	120.2	123.1	117.3	120.2	123.1	117.3	120.2	123.1	117.3

If you are not sure or have any queries, please contact your SCOTT Authorised dealer for assistance.

SPARK RC

TECHNICAL DATA

SEATPOST	mm	31.6
SEATPOST CLAMP	mm	Integrated
MAX SEATPOST INSERTION	mm	SM: 295 MD: 320 LG: 370 XL: 420
TRAVEL	mm	130 F 120 R
SHOCK LENGTH	mm	190
SHOCK STROKE	mm	45
SHOCK BUSHES	mm	20 x 8
HEADSET	mm	40/50 - 45° upper bearing 42/52 - 45° lower bearing
REAR AXLE	mm	178 x 12
BB HOUSING	mm	BSA 73 Alloy Pressfit 92 Carbon
MAX CHAIN RING		40 Tooth
MAX ROTOR REAR	mm	160
MAX TYRE WIDTH	in	2.6
CHAIN LINE	mm	55

BEARINGS:

MAIN PIVOT	61804
LINKAGE BOTTOM BRACKET	61808
LINKAGE CHAINSTAY	61900

FOR CERAMICSPEED BEARINGS, PLEASE REVIEW THE FOLLOWING TERMS CAREFULLY :

<https://ceramicspeed.com/en-eu/pages/lifetime-warranty-terms-and-conditions>

SPARK RC

SEATPOST INSERTION AND CLAMPING

The seatpost assembly is only supplied as a single unit. The sleeve, the clamp mechanism, including the clamp arm, are separate units.



To install, lightly compress the base of the seatpost clamp and slide the assembly into the frame. **Do not apply grease to the outer surfaces of the clamp or sleeve.** Align the clamping bolt with the access hole in the frame and ensure the mechanism is fully engaged with no free movement present after installation.



Tool and torque information available in the General Spare Parts chapter.

The threaded bolt inside the seatpost clamp assembly is factory-greased. If the clamp assembly is removed and replaced, reapply grease to the threaded bolt before tightening the clamp.

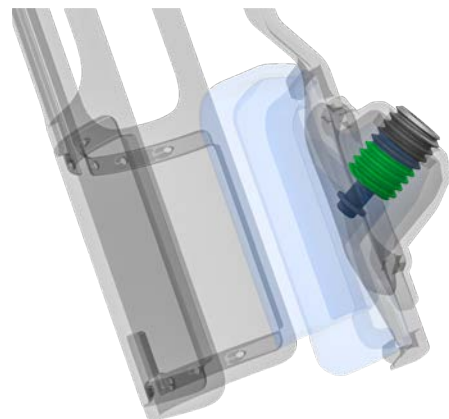

SPARK RC

For dropper seatposts, maximum insertion depth is measured from the lower edge of the actuator/cable interface. For standard seatposts, measure from the bottom end of the post.

SM: 287 mm

MED: 307 mm

LG: 348 mm

XL: 378 mm

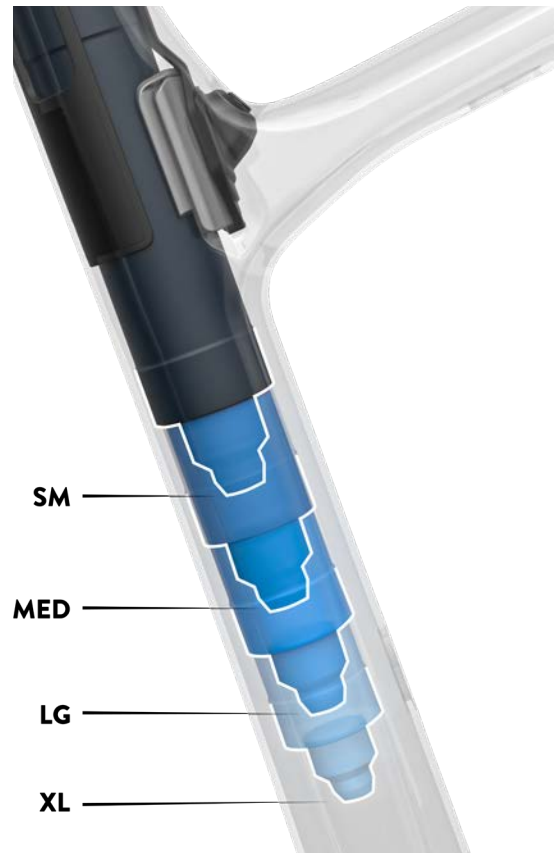

Ensure the dropper post cable is routed clear of the main pivot axle and does not contact it inside the frame.

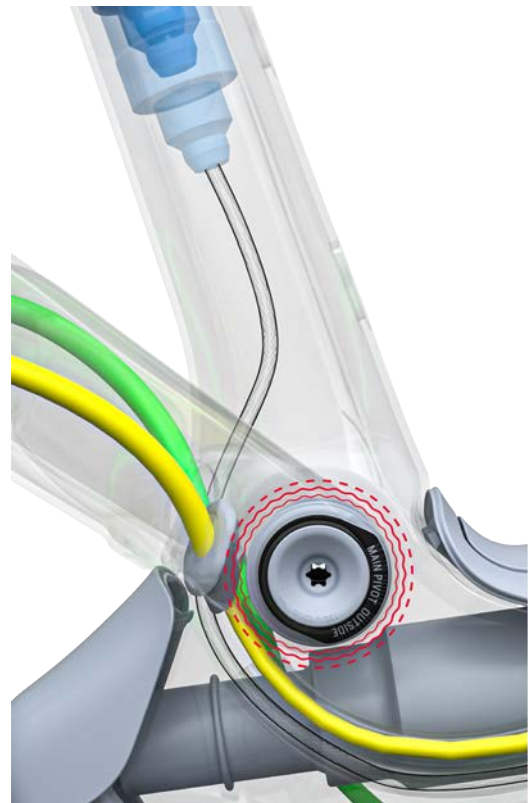

SPARK RC

ICR: INTEGRATED CABLE ROUTING

The ICR is in a fixed in position. Cable adjustment or replacement does not require any modification of the ICR system. For related procedures, refer to the Headset Adjustment chapter.



 If you are not sure or have any queries, please contact your SCOTT Authorised dealer for assistance.

SPARK RC

HEADSET ADJUSTMENT

HEADSET CUPS



Each individual headset cup will have one white coloured alignment indicator and a corresponding indent (without colour).

SPARK RC



SLACKER



STEEPER



 If you are not sure or have any queries, please contact your SCOTT Authorised dealer for assistance.

SPARK RC



Press in the headset cups by hand after installing the ICR, make sure you have the cups aligned correctly. Lightly grease the cups.

For the lower cup install the seal before the bearing, make sure the rubber side of the seal faces upwards. Grease and press in the bearing.

For the upper cup install the greased bearing first, followed by the seal. Make sure the rubber side of the seal faces upwards.

SPARK RC

UPPER HEADSET CUP ADJUSTMENT

Remove the handlebar assembly (combo or handlebar and stem) and lower the fork. Slide the spacers and headset top cover up the cables to give you access to the headset cups.

⚠ 0° headset cup installation requires disassembly and assembly of cables and related components and should be performed by an Authorized SCOTT Dealer.

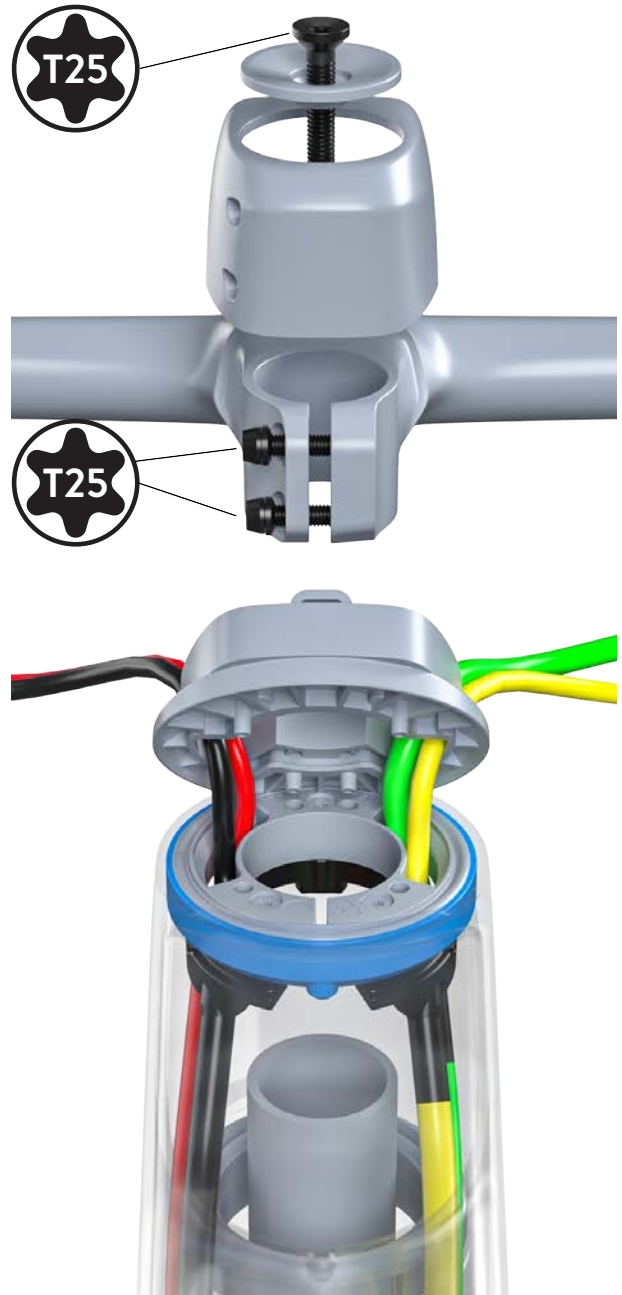

SPARK RC

Lift the upper cup out of the frame until the cup is free. Do not lift higher than necessary once clear of the frame.

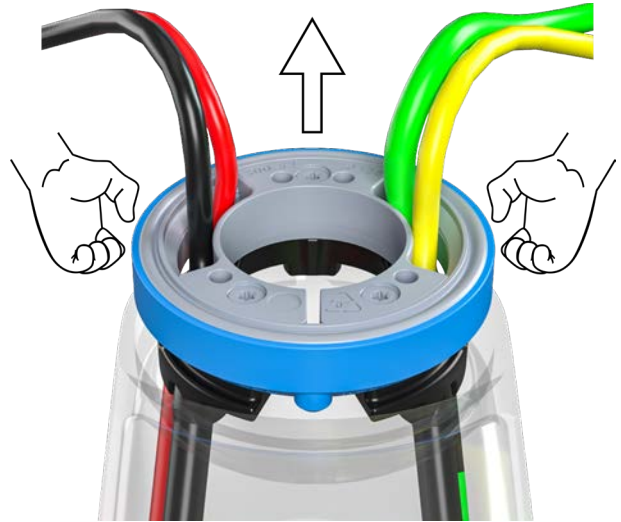

Rotate the headset cup on the bearing.



Align the headset cup with the frame alignment holes. Press the full assembly back into the frame by hand.



SPARK RC

Slide the fork back into position, mount the top cap and spacer/s. Re-assemble and align the handlebar, stem cover and compression top cap.

Tighten the stem bolts with the indicated tool and torque in a cross pattern sequence.

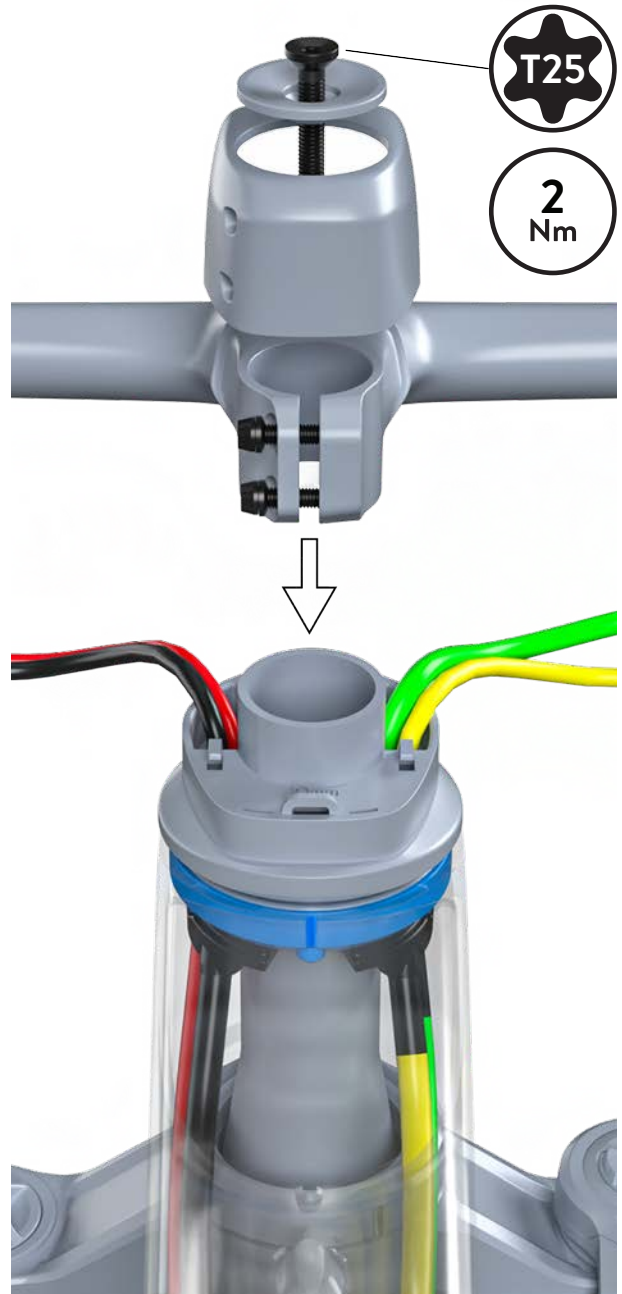

SPARK RC

LOWER HEADSET CUP ADJUSTMENT

Remove the handlebar assembly (combo or handlebar and stem) and lower the fork. Slide the spacers and headset top cover up the cables to give you access to the headset cups.

⚠ 0° headset cup installation requires disassembly and assembly of cables and related components and should be performed by an Authorized SCOTT Dealer.

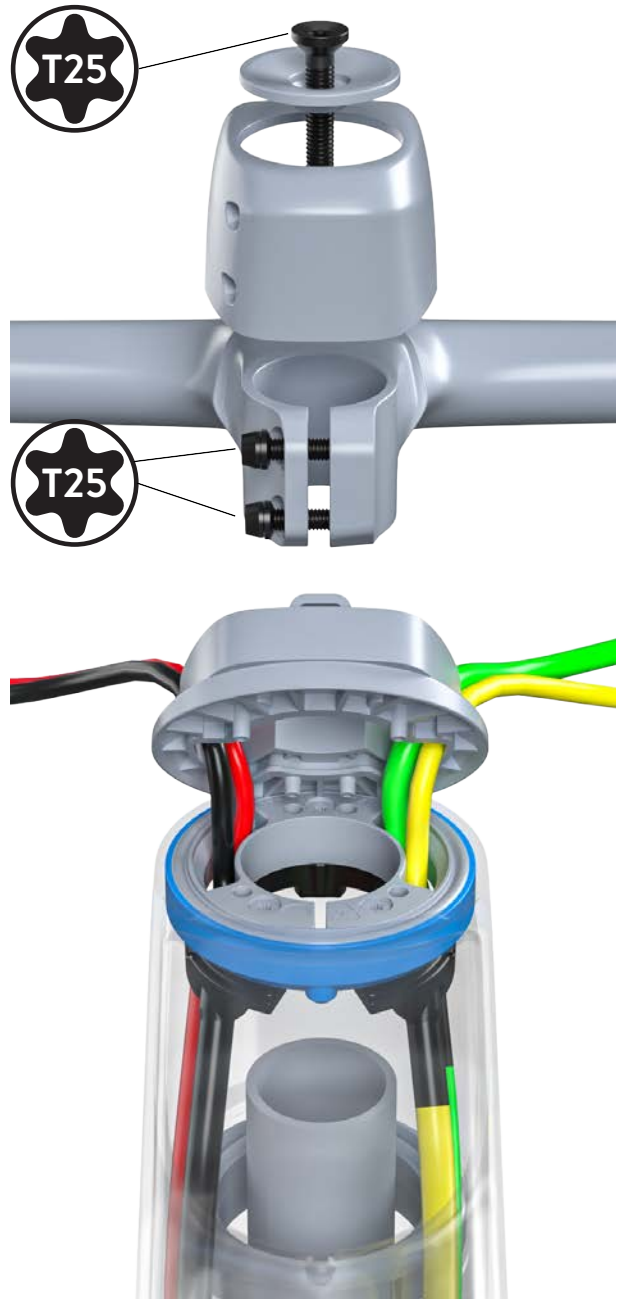

SPARK RC

Lower the fork from the frame, it is not necessary to remove the fork completely.

Remove the Fork Stopper Plate.

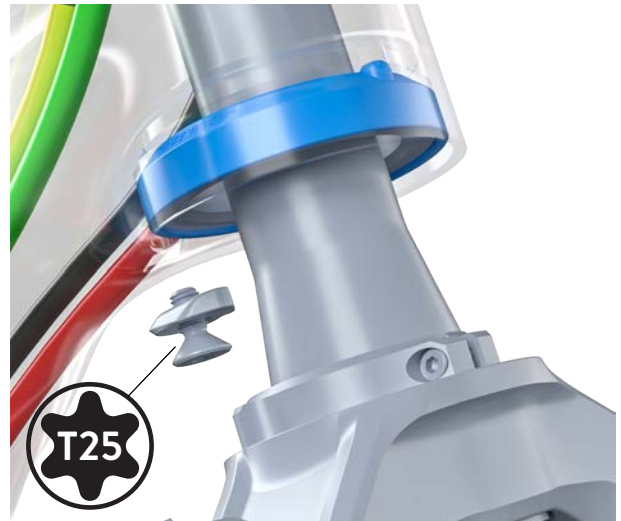

Pull the lower cup out of the frame until the cup is free. Do not lower more than necessary once clear of the frame.



Rotate the headset cup on the bearing.



SPARK RC

Align the headset cup with the frame alignment holes. Press the full assembly back into the frame by hand.

Re-assemble the Fork Stopper Plate.

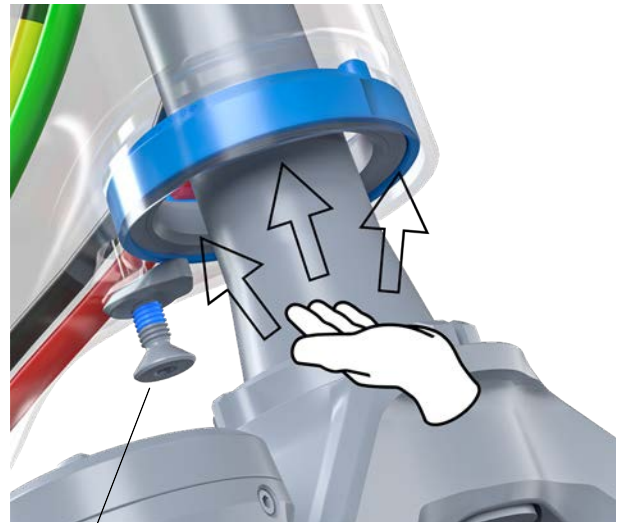

Slide the fork back into position, mount the top cap and spacer/s. Re-assemble and align the handlebar, stem cover and compression top cap.

Tighten the stem bolts with the indicated tool and torque in a cross pattern sequence.

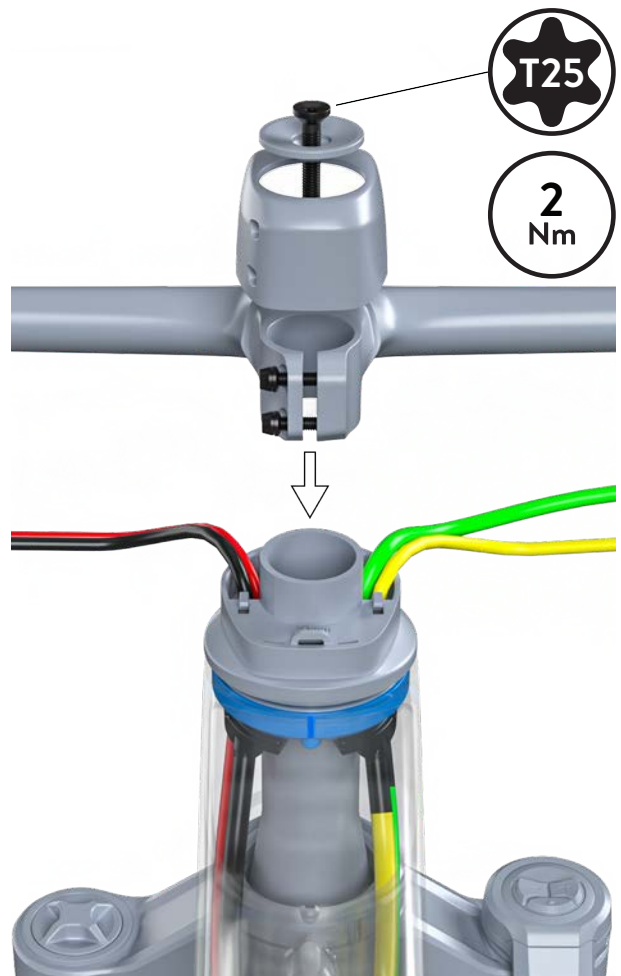

SPARK RC

SYNCROS SAVE THE DAY KIT

The SYNCROS Save the Day Kit is integrated into the downtube. The kit includes a mini pump, tyre levers, and a 29" TP Inner Tube.



SPARK RC

The Syncros Save the Day Kit is easy to remove as all the cables are neatly set into position with the ICR. A simple process of pulling on the tab to remove. Once re-installed back into the frame the Save the Day Kit must be secured by the small plastic tab.

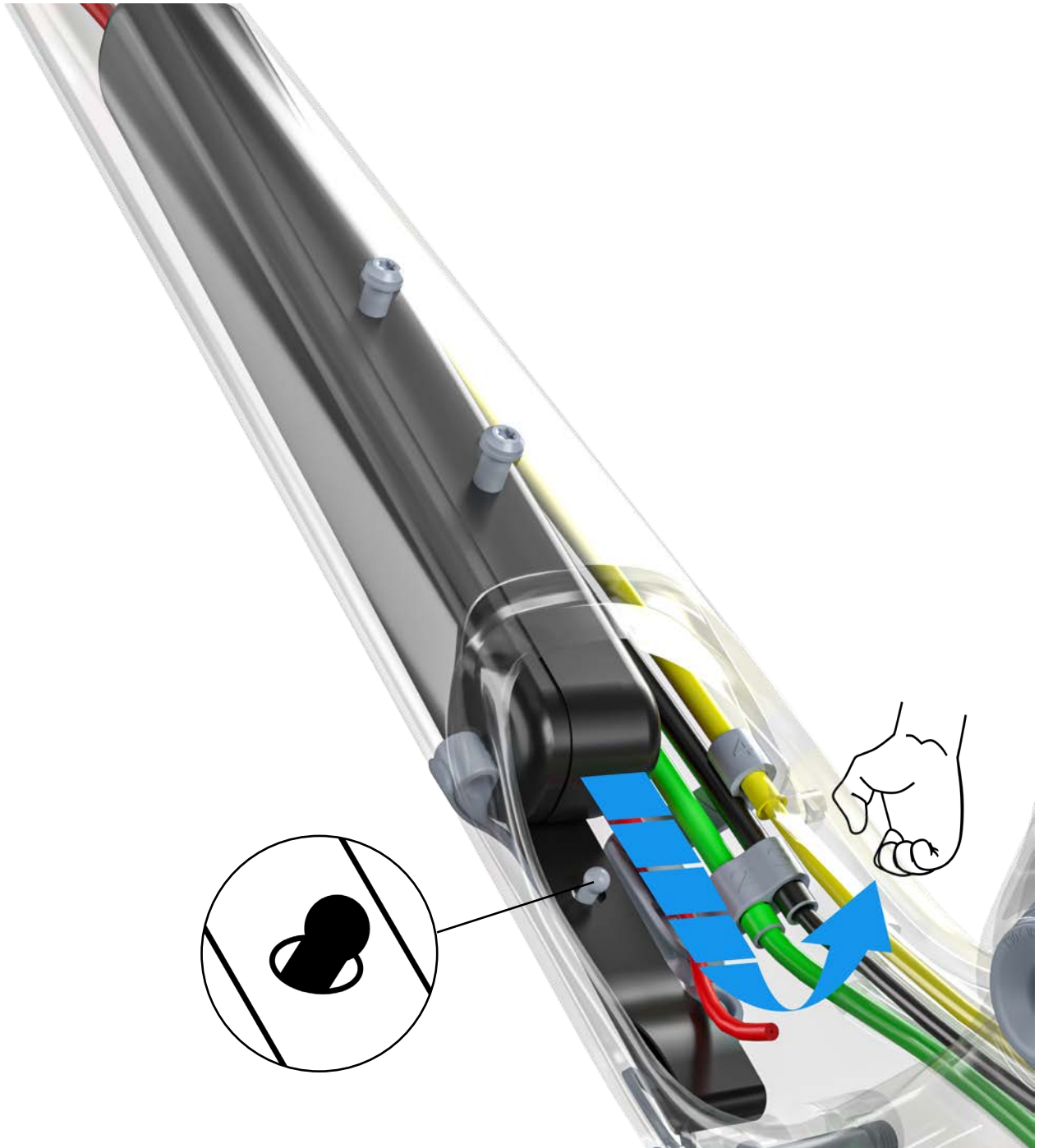

SPARK RC

BOTTLE CAGE BRACKET

The specially engineered seat tube bottle cage bracket features a tool-free, boltless mounting system. Its clip-on design enables quick installation and removal via a push-button release mechanism.

Align the bottle cage bracket with the mounting openings on the seat tube.



Slide the bracket downward until it fully engages with the frame interface (cut away image). Ensure the bracket is securely locked into position before installation of the bottle cage.



SPARK RC

To remove the bracket, press the release button located in the center of the bracket and slide the assembly upward.



Position the bottle cage onto the bracket and install the mounting bolts using the correct tool. Apply a thin layer of grease to the bottle cage bolts before installation. Tighten the bolts to the torque specification recommended for the bottle cage.



SPARK RC

SETTING SAG

The Spark RC 2027 SAG set-up is based around the bottom bracket linkage with a clean and simple function. **25% SAG is recommended.**

Make sure the bottom bracket linkage and the SAG Ring are positioned together at 0% (with slight off-set).



Sit on the saddle gently in a neutral riding position without bouncing the suspension. Wear all normal riding equipment, including your backpack, helmet, and protective gear, as these affect the suspension load. Under rider weight, the linkage and SAG Ring will move together.

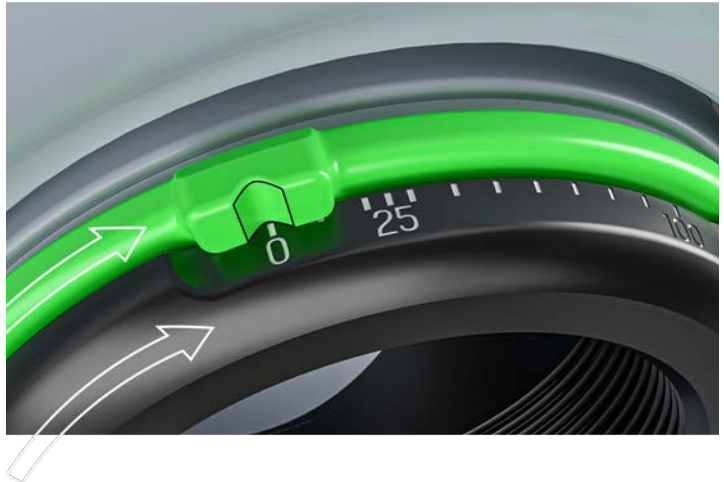

Carefully lift yourself off the saddle without compressing or rebounding the suspension. The linkage will return to its original position while the SAG Ring remains at the compression point, indicating the current SAG percentage. Compare the indicated value with the recommended SAG setting and adjust the rear shock air pressure accordingly until the desired SAG is achieved.



SPARK RC

GENERAL SPARE PARTS

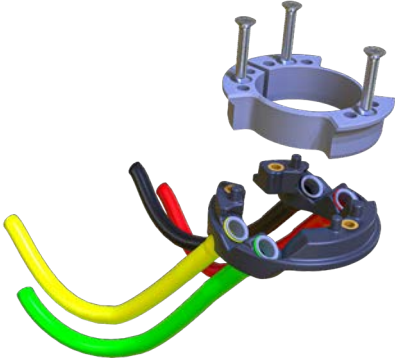

427747 SCO HEADSET CABLE KIT ICR SPARK 27



427845 SCO TOOL/CABLE HOLDER KIT SPARK 27



428013 SCO SWINGARM BRAKE HOSE PORT SPARK RC 27



428014 SCO SWINGARM GEAR HOSE PORT SPARK 27

SPARK RC



428018 SCO PIVOT SCREW KIT TITANIUM SPARK RC 27



428019 SCO PIVOT SCREW KIT STAINLESS SPARK RC 27



427739 SCO SWINGARM REP KIT SPARK RC 27

428614 SCO SWINGARM STAINLESS STEEL BEARINGS SPARK RC 27

428616 SCO SWINGARM CERAMIC BEARINGS SPARK RC 27



428020 SCO MAIN PIVOT AXLE ALLOY SPARK RC 27



428021 SCO MAIN PIVOT AXLE CARBON SPARK RC 27

SPARK RC



427512 SCO LOWER LINK ALLOY SPARK RC 27

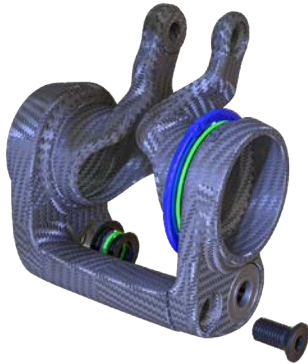

427511 SCO LOWER LINK CARBON SPARK RC 27



428204 SCO CARBON LINK SEAL SPARK 27

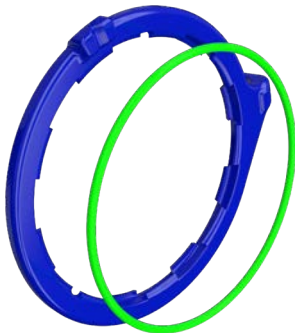

427514 SCO SAG INDICATOR SPARK 27

SPARK RC



428017 SCO HEADSET COVER KIT ICR SPARK RC 27



428012 SCO SEATPOST CLAMP SLEEVE SPARK RC 27



427516 SCO SEATPOST CLAMP SPARK RC TITINIUM 27



427773 SCO HEADTUBE COVER SPARK RC SL 27

427774 SCO HEADTUBE COVER SPARK RC W/C EVO 27

427775 SCO HEADTUBE COVER SPARK RC W/C 27

427776 SCO HEADTUBE COVER SPARK RC EXPERT 27

427777 SCO HEADTUBE COVER SPARK RC T.I BLK 27

427778 SCO HEADTUBE COVER SPARK RC T.I GRY 27

427779 SCO HEADTUBE COVER SPARK RC T.I BLU 27

427784 SCO HEADTUBE COVER SPARK RC PRO 27

427786 SCO HEADTUBE COVER SPARK RC TEAM GRY 27

427787 SCO HEADTUBE COVER SPARK RC TEAM GRN 27

427788 SCO HEADTUBE COVER SPARK RC COMP 27

SPARK RC



428022 SCO HEADSET CUP KIT SPARK 27



428113 SCO HEADSET BEARINGS SPARK 27



428016 SCO HEADSET COVER KIT ECR SPARK RC 27



427517 SCO FORK LOCK STOP KIT SPARK 27



427769 SCO MAIN PIVOT COVER SPARK RC BLK MAT 27

427770 SCO MAIN PIVOT COVER SPARK RC COMP 27

427772 SCO MAIN PIVOT COVER SPARK RC EXPERT 27

427529 SCO MAIN PIVOT COVER SPARK RC T.I BLU 27

427520 SCO MAIN PIVOT COVER SPARK RC TEAM GRY 27



SPARK RC



427519 SCO T-TYPE STOP SCREW SPARK 27

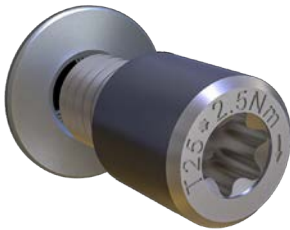

427515 SCO UDH STOP SCREW SPARK 27



427562 SCO CHAINGUIDE SPARK RC 27



428015 SCO BOTTLE CAGE BRACKET SPARK RC 27

SPARK RC



427500 SCO SHOCK COVER SPARK RC BLK MATT 27

427533 SCO SHOCK COVER SPARK RC COMP 27

427530 SCO SHOCK COVER SPARK RC EXPERT 27

427531 SCO SHOCK COVER SPARK RC T.I BLU 27

427532 SCO SHOCK COVER SPARK RC TEAM GRY 27



297136 SCO BOTTLE CAGE INSERTS SCALE HMX-SL 23



428023 SCO SEATTUBE CABLE RUBBERS SPARK RC 27



428038 SCO SHOCK WINDOW RUBBER SPARK RC 27

SPARK RC



428160 SCO CS/SS PROTECTOR GLUE SPARK RC 27



428024 SCO AXLE RWS REAR 148X12 SPARK RC 27



286000 SCO DROPOUT SRAM UDH 21



427087 SYN SAVE THE DAY KIT IS-M100

MANUFACTURER'S GUARANTEE,

When purchasing a new SCOTT bicycle from an authorized SCOTT dealer, SCOTT grants a manufacturer's guarantee subject to the following provisions.

CONDITIONS

The manufacturer's guarantee is only granted to the first-time buyer of a SCOTT bicycle who has purchased it from an authorized SCOTT dealer. The manufacturer's guarantee only applies if the bicycle is registered to the first buyer at www.scott-sports.com within one year of purchase.

DURATION

The manufacturer's guarantee is granted from the date of purchase for a period of five years on bicycle frames and rear ends. The guarantee period is reduced to three years, if the SCOTT bicycle is not serviced at least once a year by an authorized SCOTT dealer. Maintenance services must be carried out in accordance with the maintenance instructions in the SCOTT manual and must be confirmed there by the stamp and signature of the authorized SCOTT dealer.

For frames and rear ends of Category 5 bicycle models and for rigid forks manufactured by SCOTT, the duration of the manufacturer's guarantee is limited to two years.

If a defect on the SCOTT bicycle is remedied within the scope of a manufacturer's guarantee or a warranty claim, the duration of the manufacturer's guarantee is not extended. The manufacturer's guarantee ends, when the first-time buyer transfers ownership of the SCOTT bicycle to a third person.

ASSERTION

The manufacturer's guarantee is provided by SCOTT Sports SA, Route du Crochet 11, 1762 Givisiez, Switzerland. The buyer must inspect the SCOTT bicycle immediately after purchase and notify his authorized SCOTT dealer at once in writing of any obvious defects. Hidden defects must be reported immediately after their discovery. In the event of a guarantee claim, the SCOTT bicycle must be handed over to an authorized SCOTT dealer. The latter will contact SCOTT to remedy the defect. The assertion of a guarantee claim always requires the presentation of the original proof of purchase as well as the proof of maintenance service in the SCOTT manual.

Performance of SCOTT in the event of a guarantee claim

In the event of a guarantee claim, SCOTT will, at its own discretion, repair the defect or replace the defective product with a product of similar quality, whereby colour and model deviations are possible. If a repair or replacement is not possible, a purchase price refund will be made taking into account previous use. SCOTT is entitled to commission third parties to remedy the defect.

LIMITATIONS

The manufacturer's guarantee applies exclusively to frames, swingarms and rigid forks of SCOTT bicycles. Bicycle components are excluded from this manufacturer's guarantee.

The manufacturer's guarantee does not apply to normal wear and tear, damage caused by accidents or other excessive force on the SCOTT bicycle, corrosion, improper maintenance, incorrect assembly and assembly of unsuitable components or accessories as well as cosmetic defects, for example in the varnish.

The manufacturer's guarantee does not apply to SCOTT bicycles that have been used in a rental shop.

MISCELLANEOUS

These manufacturer's guarantee provisions apply to all SCOTT bicycles as of model year 2023. Statutory warranty rights of the buyer and guarantees of component manufacturers (Shimano, SRAM etc.) remain unaffected by this manufacturer's guarantee. The place of jurisdiction for all disputes in connection with this manufacturer's guarantee is Freiburg, Switzerland. This manufacturer's guarantee is subject to Swiss law to the exclusion of all legislation that refers to foreign law.

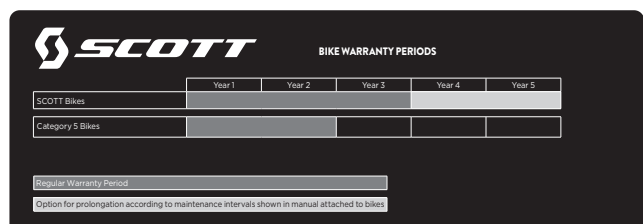

	Year 1	Year 2	Year 3	Year 4	Year 5
SCOTT Bikes					
Category 5 Bikes					
Original Warranty Period					
Option for prolongation according to maintenance intervals shown in manual attached to bikes					



All rights reserved
© 2027 SCOTT Sports SA

Distribution:
SSG (Europe) Distribution Center SA
P.E.D. Zone C1
Rue du Kiell 60
6790 Aubange
Belgium

SCOTT Sports SA
Route du Crochet 11
1762 Givisiez
Switzerland

www.scott-sports.com|contact
www.scott-sports.com

